

# LINEARPOTI

*Linearpotentiometer, Cylindrical Housing*



*Series  
LZW*

- *Brackets self adjustend*
- *Range 50 - 750 mm*
- *Protection IP 65*
- *Displacement speed < 5 m/s*
- *Linearity  $\pm 0,05\%$*
- *Infinite resolution*
- *Working temperature -30...+100°C*
- *Lifetime >25x10<sup>6</sup> meters or >100x10<sup>6</sup> cycles*
- *Electrical Connection*
  - 4-pin connector according DIN 43650-ISO4400 (standard)*
  - 5-pin circular connector*

## Technical data

<b>range</b>	50/100/130/150/175/200/225/275/300/375/400/450/500/600/750 mm		
<b>protection</b>	IP 65	<b>max. supply voltage</b>	60 V
<b>displacement speed</b>	<5 m/s	<b>temp. Coeff. Of the resistance</b>	-200 ±200 ppm/°C
<b>displacement force</b>	<10 N	<b>eff. Temp. Coeff. Of output voltage</b>	<1,5 ppm/°C
<b>linearity</b>	±0,05%	<b>electrical isolation</b>	>100 MOhm at 500 V
<b>resolution</b>	infinite	<b>dielectric strength</b>	>500 Veff at 50 Hz
<b>tolerance on resistance</b>	±20%	<b>working temperature</b>	-30...+100°C
<b>recommended cursor current</b>	<1 µA	<b>storage temperature</b>	-50...+120°C
<b>max. cursor current</b>	<10 mA	<b>rod material</b>	stainless steel AISI 431
<b>max. dissipation at 40°C</b>	3 W	<b>case material</b>	anodised aluminium, nylon 66 GF 40
<b>max. angular tolerance</b>	±30°	<b>fixing</b>	bearings

## Dimension and Electrical Data

range		50	100	130	150	175	200	225	275	300	375	400	450	500	600	750	
electrical stroke (ENB) +3/-0	mm	50	100	130	150	175	200	225	275	300	375	400	450	500	600	750	
theoretical electr. stroke (TN) ±1	mm	ENB+3					ENB + 4					380	406	457	508	609	762
resistance	kOhm	5					5					5	5	5	5	5	10
mechanical stroke (MH)	mm	ENB + 9					ENB + 10					386	412	463	518	619	772
case length (A)	mm	ENB + 129					ENB + 130					512	538	589	664	765	918
min. distance between bearings (B)	mm	ENB + 181					ENB + 182					564	590	641	716	817	970

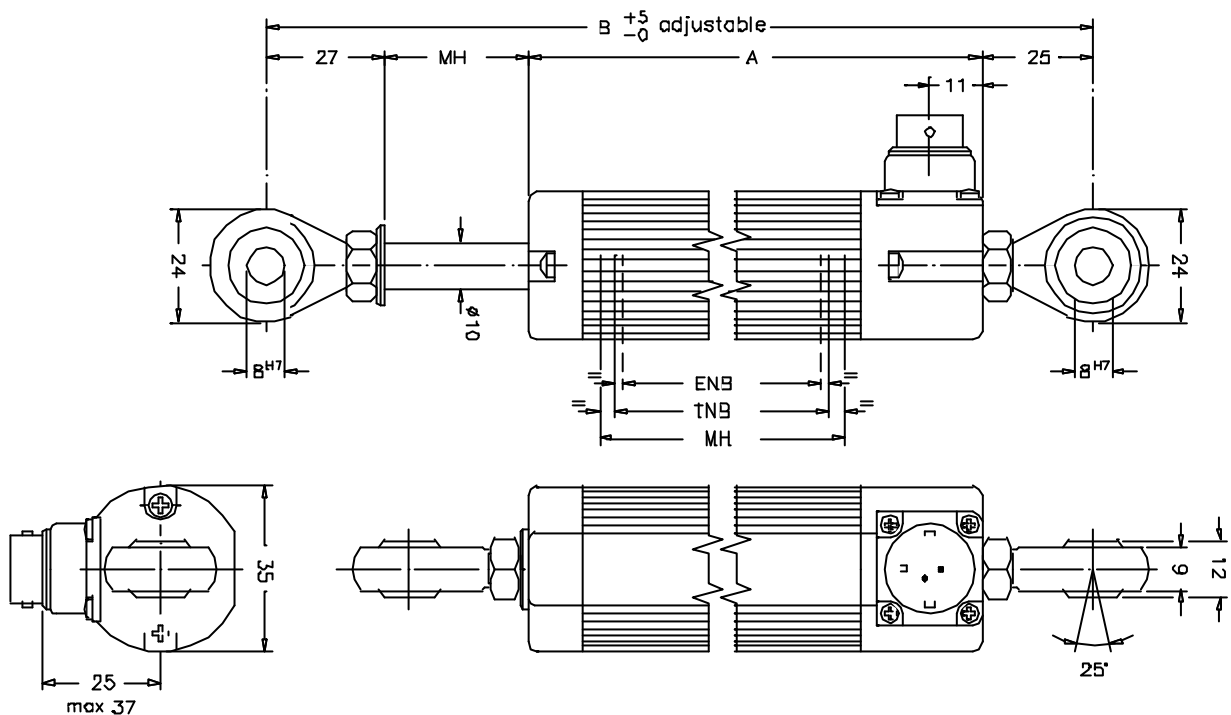

## Connection and Accessories

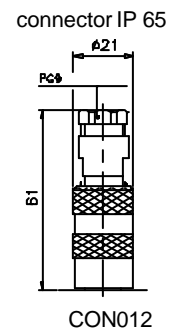
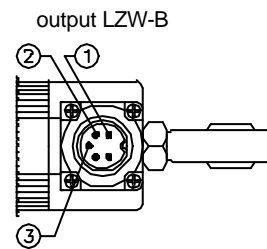
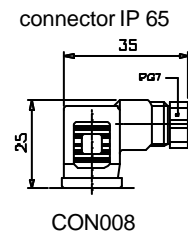
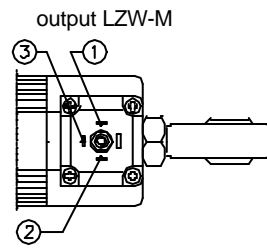
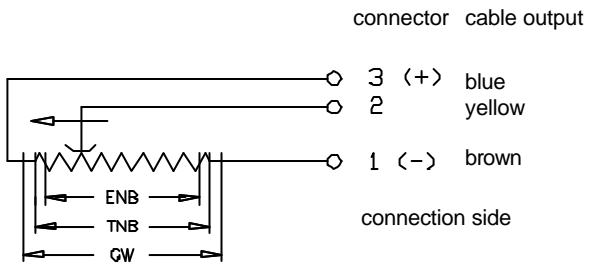

## Order Code

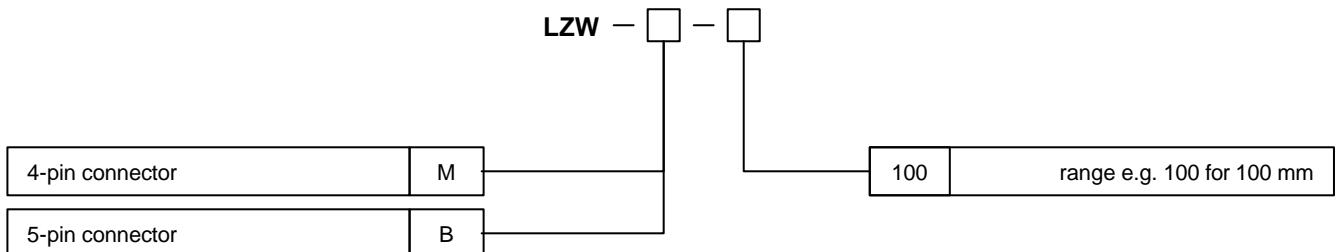

## Price List

50 mm	LZW-M- 50	164 €
100 mm	LZW-M-100	170 €
130 mm	LZW-M-130	172 €
150 mm	LZW-M-150	180 €
175 mm	LZW-M-175	185 €
200 mm	LZW-M-200	190 €
225 mm	LZW-M-225	196 €
275 mm	LZW-M-275	202 €
300 mm	LZW-M-300	207 €
375 mm	LZW-M-375	215 €
400 mm	LZW-M-400	217 €
450 mm	LZW-M-450	229 €
500 mm	LZW-M-500	236 €
600 mm	LZW-M-600	252 €
750 mm	LZW-M-750	295 €

### optional

4-pin connector DIN 43650-ISO4400	LZW-M-XXX	standard
5-pin. connector	LZW-B-XXX	11 €

other options on request

### accessories

4-pin connector IP 65	CON008	7 €
5-pin connector IP 65	CON012	16 €

---

#### WayCon Positionsmesstechnik GmbH

e-mail: [info@waycon.de](mailto:info@waycon.de)

internet: [www.waycon.de](http://www.waycon.de)



#### Head Office

Inselkammerstr. 8

82008 Unterhaching

Tel. +49 (0)89 61 20 84 70

Fax +49 (0)89 61 20 84 83

#### Office Köln

Alte Fischenicher Str. 46

50997 Köln

Tel. +49 (0)2232 96 58 03

Fax +49 (0)2232 96 58 05

---