

LINEARPOTI

Linearpotentiometer, Rectangular Housing

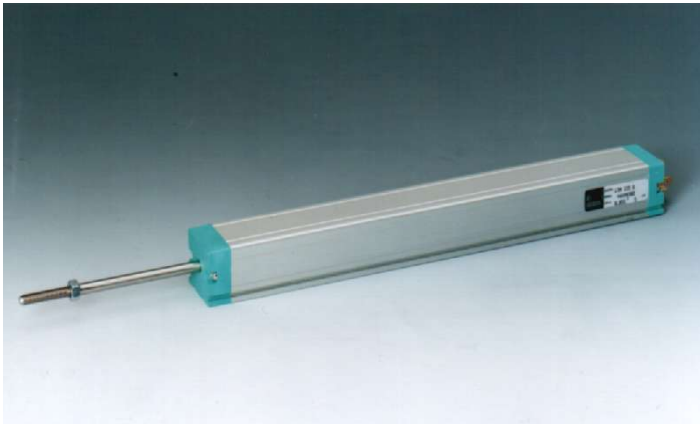

Series LRW

- **Rectangular Displacement Transducer, Thread: M6**
- **Range 50 - 900 mm**
- **Protection IP 60 (on request IP 65, IP67)**
- **Displacement speed < 5 m/s (on request <10 m/s)**
- **Linearity $\pm 0,05\%$**
- **Infinite resolution**
- **Working temperature -30...+100°C**
- **Lifetime >25x10⁶ meters
or >100x10⁶ cycles**
- **Electrical Connection**
4-pin connector according DIN 43650-ISO4400 (standard)
5-pin circular connector

Technical Data

Range	50/100/130/150/175/200/225/275/300/375/400/450/500/600/750/900 mm		
Protection	IP 60, optional IP 65, 67	Max. supply voltage	60 V
Displacement speed	<10 m/s optional	Temp. coeff. of the resistance	-200 ±200 ppm/°C
Displacement force	<2 N IP 60, <10 N IP 65	Eff. temp. coeff. of output voltage	<1,5 ppm/°C
Linearity	±0,05%	Electrical isolation	>100 MOhm at 500 V
Resolution	infinite	Dielectric strength	>500 Vpp at 50 Hz
Tolerance on resistance	±20%	Working temperature	-30...+100°C
Recommended cursor current	<1 µA	Storage temperature	-50...+120°C
Max. cursor current	<10 mA	Rod material	Stainless steel AISI 431
Max. dissipation at 40°C	3 W	Case material	Anodised aluminium Nylon 66 GF 40
		Fixing	Brackets

Dimensions and Electrical Data

Range	50	100	130	150	175	200	225	275	300	375	400	450	500	600	750	900
Electrical stroke (ENB) +3/-0	50	100	130	150	175	200	225	275	300	375	400	450	500	600	750	900
Theoretical electr. stroke (TN) ±1	ENB+3					ENB + 4				380	406	457	508	609	762	914
Resistance	5					5				5	5	5	5	5	10	10
Mechanical stroke (MH.)	ENB + 9					ENB + 10				386	412	463	518	619	772	924
Case length (A)	ENB + 62					ENB + 63				439	465	516	571	672	825	977
Case length (A) IP67	ENB + 71,5					ENB + 72,5				448,5	474,5	525,5	580,5	681,5	834,5	986,5

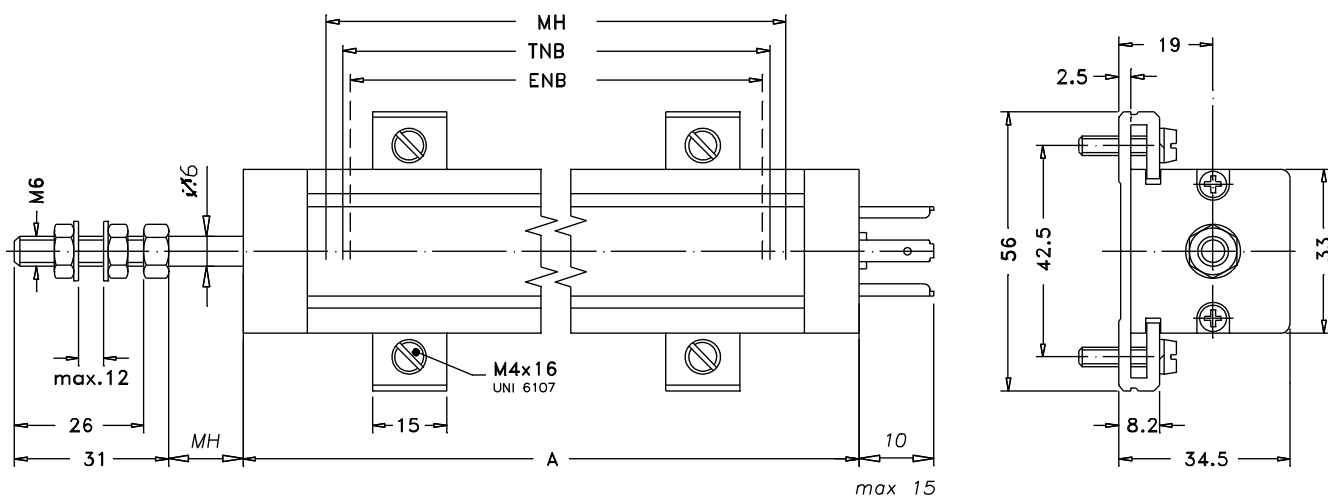

Connection and Accessories

Output LRW-M

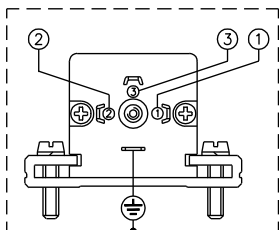

Output LRW-B

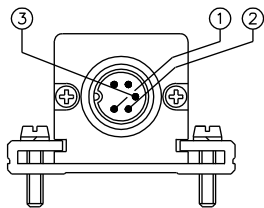

Ausgang LRW-IP

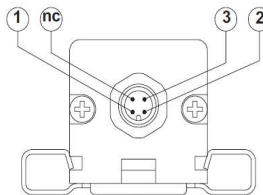

connector cable output

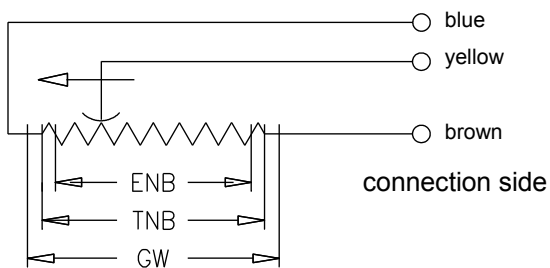

Connector IP 65

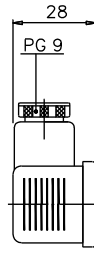

CON006

Connector IP 67

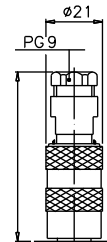

CON012

coupling ball joint

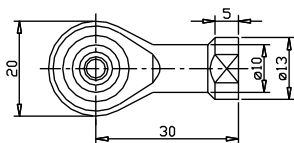

PKIT 015

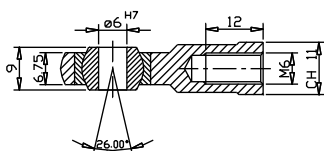

Order Code

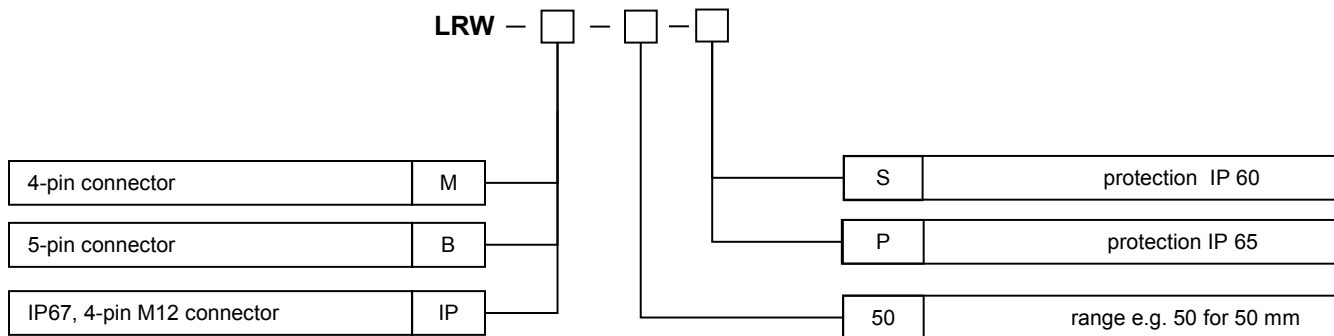

Price List

50 mm	LRW-M- 50-S
100 mm	LRW-M-100-S
130 mm	LRW-M-130-S
150 mm	LRW-M-150-S
175 mm	LRW-M-175-S
200 mm	LRW-M-200-S
225 mm	LRW-M-225-S
275 mm	LRW-M-275-S
300 mm	LRW-M-300-S
375 mm	LRW-M-375-S
400 mm	LRW-M-400-S
450 mm	LRW-M-450-S
500 mm	LRW-M-500-S
600 mm	LRW-M-600-S
750 mm	LRW-M-750-S
900 mm	LRW-M-900-S

Optional

4-pin connector DIN 43650-ISO4400	LRW-M-XXX-X	standard
5-pin connector output	LRW-B-XXX-X	
4-pin M12 connector IP67	LRW-IP-XXX-X	
protection IP 65	LRW-X-XXX-P	

Accessories

Fixing kit for LRW:	PKIT009
2 brackets, screws, lock-washer	

Cable with female connector M12 für LRW-IP

K4P2M-S-M12	2 m, axial female connector
K4P5M-S-M12	5 m, axial female connector
K4P10M-S-M12	10 m, axial female connector
K4P2M-SW-M12	2 m, radial female connector
K4P5M-SW-M12	5 m, radial female connector
K4P10M-SW-M12	10 m, radial female connector

Connector 4-pin für LRW-M

CON006 radial connector

Connector 5-polig für LRW-B

CON011 (IP40) axial connector

Connector M12 für LRW-IP

D4-G-M12-S M12 axial female connector
 D4-W-M12-S M12 radial female connector

These data can be changed without any advance notice

WayCon Positionsmesstechnik GmbH

e-mail: info@waycon.de
 internet: www.waycon.de

Head Office

Mehlbeerenstraße 4
 82024 Taufkirchen
 Tel. +49 (0)89 67 97 13-0
 Fax +49 (0)89 67 97 13-250

Office Brühl

Auf der Pehle 1
 50321 Brühl
 Tel. +49 (0)2232 56 79 44
 Fax +49 (0)2232 56 79 45



Positionsmesstechnik