

LINEARPOTI

Linearpotentiometer, Cylindrical Housing



Series LZW

- **Brackets self adjustend**
- **Range 50 - 750 mm**
- **Protection IP 65**
- **Displacement speed < 5 m/s**
- **Linearity $\pm 0,05\%$**
- **Infinite resolution**
- **Working temperature -30...+100°C**
- **Lifetime >25x10⁶ meters or >100x10⁶ cycles**
- **Electrical Connection**
4-pin connector according DIN 43650-ISO4400 (standard)
5-pin circular connector

Technical data

range	50/100/130/150/175/200/225/275/300/375/400/450/500/600/750 mm		
protection	IP 65	max. supply voltage	60 V
displacement speed	<5 m/s	temp. coeff. of the resistance	-200 ±200 ppm/°C
displacement force	<10 N	eff. temp. coeff. of output voltage	<1,5 ppm/°C
linearity	±0,05%	electrical isolation	>100 MOhm at 500 V
resolution	infinite	dielectric strength	>500 Veff at 50 Hz
tolerance on resistance	±20%	working temperature	-30...+100°C
recommended curser current	<1 µA	storage temperature	-50...+120°C
max. curser current	<10 mA	rod material	stainless steel AISI 431
max. dissipation at 40°C	3 W	case material	anodised aluminium, nylon 66 GF 40
max. angular tolerance	±30°	fixing	bearings

Dimension and Electrical Data

range		50	100	130	150	175	200	225	275	300	375	400	450	500	600	750
electrical stroke (ENB) +3/-0	mm	50	100	130	150	175	200	225	275	300	375	400	450	500	600	750
theoretical electr. stroke (TN) ±1	mm	ENB+3			ENB + 4			380			406	457	508	609	762	
resistance	kOhm	5			5			5			5	5	5	5	5	10
mechanical stroke (MH)	mm	ENB + 9			ENB + 10			386			412	463	518	619	772	
case length (A)	mm	ENB + 129			ENB + 130			512			538	589	664	765	918	
min. distance between bearings (B)	mm	ENB + 181			ENB + 182			564			590	641	716	817	970	

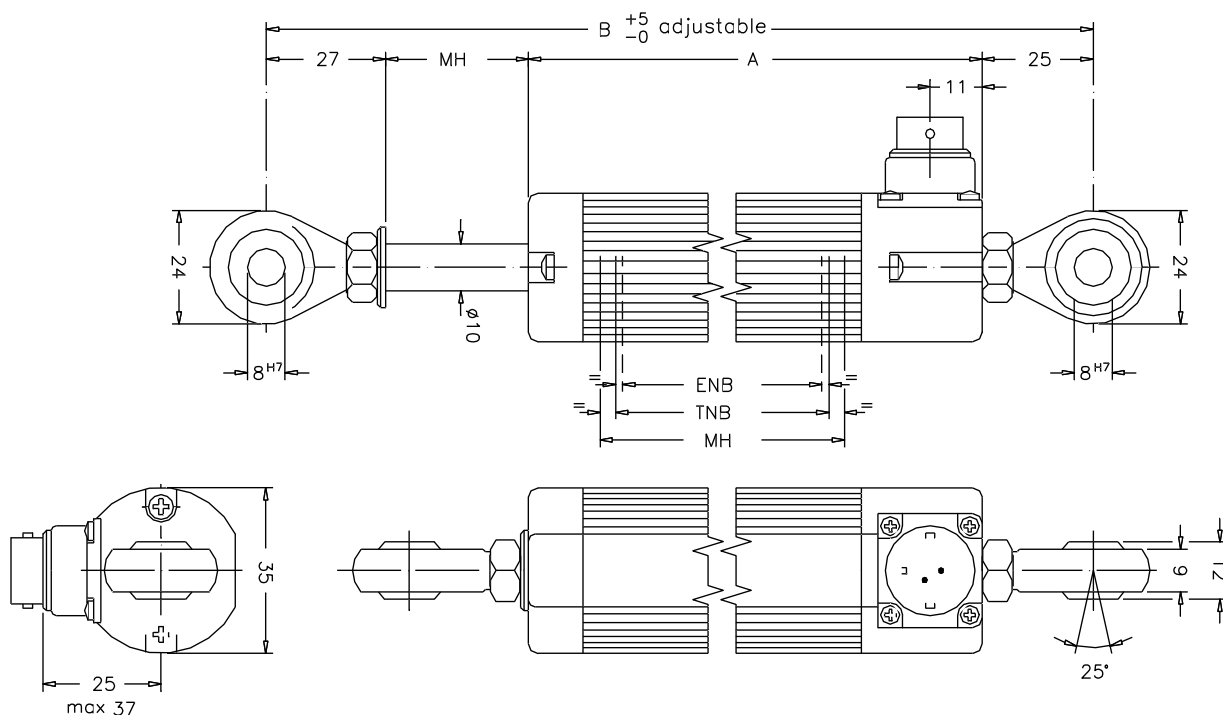

Connection and Accessories

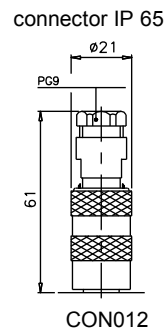
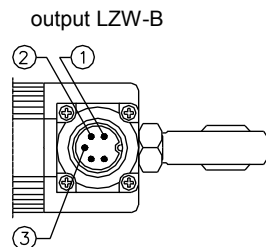
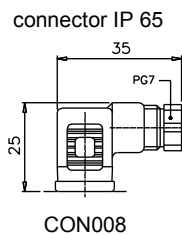
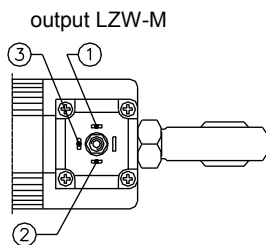
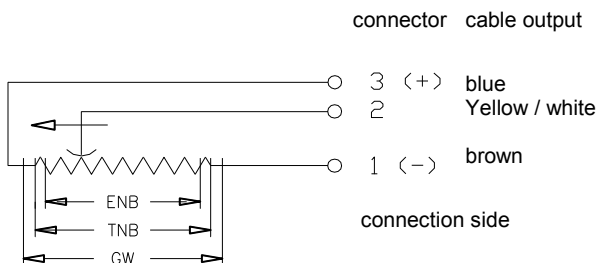

Order Code

LZW — □ — □

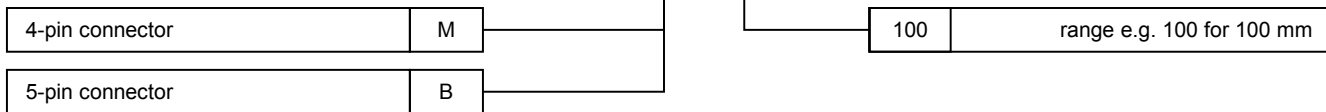

Price List

50 mm	LZW-M- 50	164 €
100 mm	LZW-M-100	170 €
130 mm	LZW-M-130	172 €
150 mm	LZW-M-150	180 €
175 mm	LZW-M-175	185 €
200 mm	LZW-M-200	190 €
225 mm	LZW-M-225	196 €
275 mm	LZW-M-275	202 €
300 mm	LZW-M-300	207 €
375 mm	LZW-M-375	215 €
400 mm	LZW-M-400	217 €
450 mm	LZW-M-450	229 €
500 mm	LZW-M-500	236 €
600 mm	LZW-M-600	252 €
750 mm	LZW-M-750	295 €

optional

4-pin connector DIN 43650-ISO4400	LZW-M-XXX	standard
5-pin. connector	LZW-B-XXX	11 €

other options on request

accessories

4-pin connector IP 65	CON008	7 €
5-pin connector IP 65	CON012	16 €

These data can be changed without any advance notice

WayCon Positionsmesstechnik GmbH

e-mail: info@waycon.de
internet: www.waycon.de



Head Office

Mehlbeerenstraße 4
82024 Taufkirchen
Tel. +49 (0)89 67 97 13-0
Fax +49 (0)89 67 97 13-250

Office Brühl

Auf der Pehle 1
50321 Brühl
Tel. +49 (0)2232 567944
Fax +49 (0)2232 567945